

## Handout 24. Programming Thymio: Introduction to the VPL interface

**Instruction:** Place two cards in the center and change them to reproduce the program below. Then circle the correct answers based on what happens.

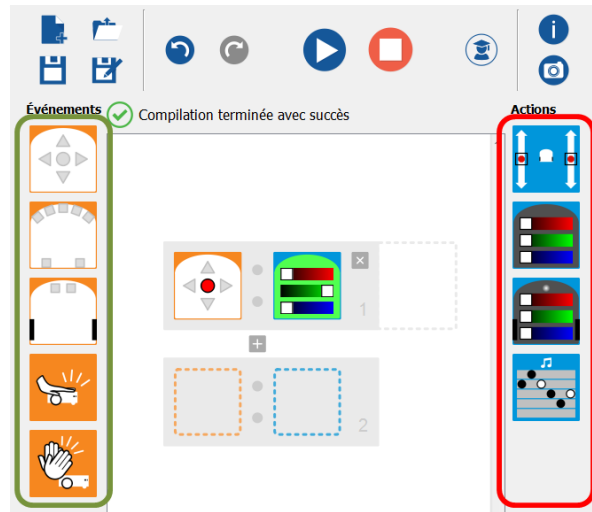

Commentaire [L1]: since V1.4 the interface is French only

The button  is used to: *Start the program* *Stop the program*

The button  is used to: *Start the program* *Stop the program*

The images in the green box are: *Actions* *Sensors*

The images in the red box are: *Actions* *Sensors*



The "+" button outlined in green is used to: *Delete an order* *Add an order*

The button "x" outlined in red is used to: *Delete an order* *Add an order*